

Antigua

IPL-1515

Equipment Manufacturer

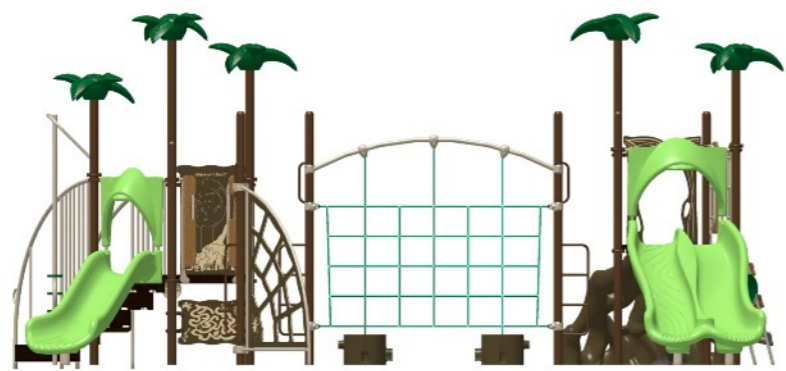

FRONT



SIDE





Playworld Systems, Inc.
 1000 Buffalo Road
 Lewisburg, PA
 17837-9795 USA

EQUIPMENT SIZE:
7,85M x 4,88M x 3,58M

USE ZONE:
11,08M x 8,53M

AREA: **76,45 SqM.** PERIMETER: **36,58M**

FALL HEIGHT:
2,40M

USER CAPACITY: **38** AGE GROUP: **6-14**

ADA SCHEDULE	Total Elevated Play Activities: 8		
	Total Ground-Level Play Activities: 3		
	Accessible Elevated Activities	Accessible Ground-Level Activities	Accessible Ground-Level Play Types
Required	4	3	3
Provided	5	3	3

✓ EN-1176



PROJECT NO:
IPL-1515A

SCALE:
1:50

DRAWN BY:
S. KUHNS

Paper Size

DATE:
01-FEB-16

A3

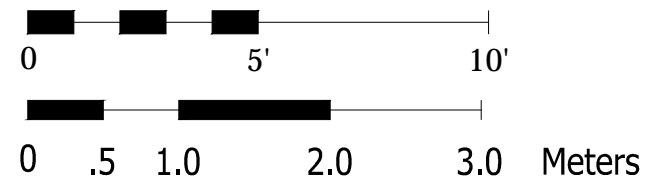
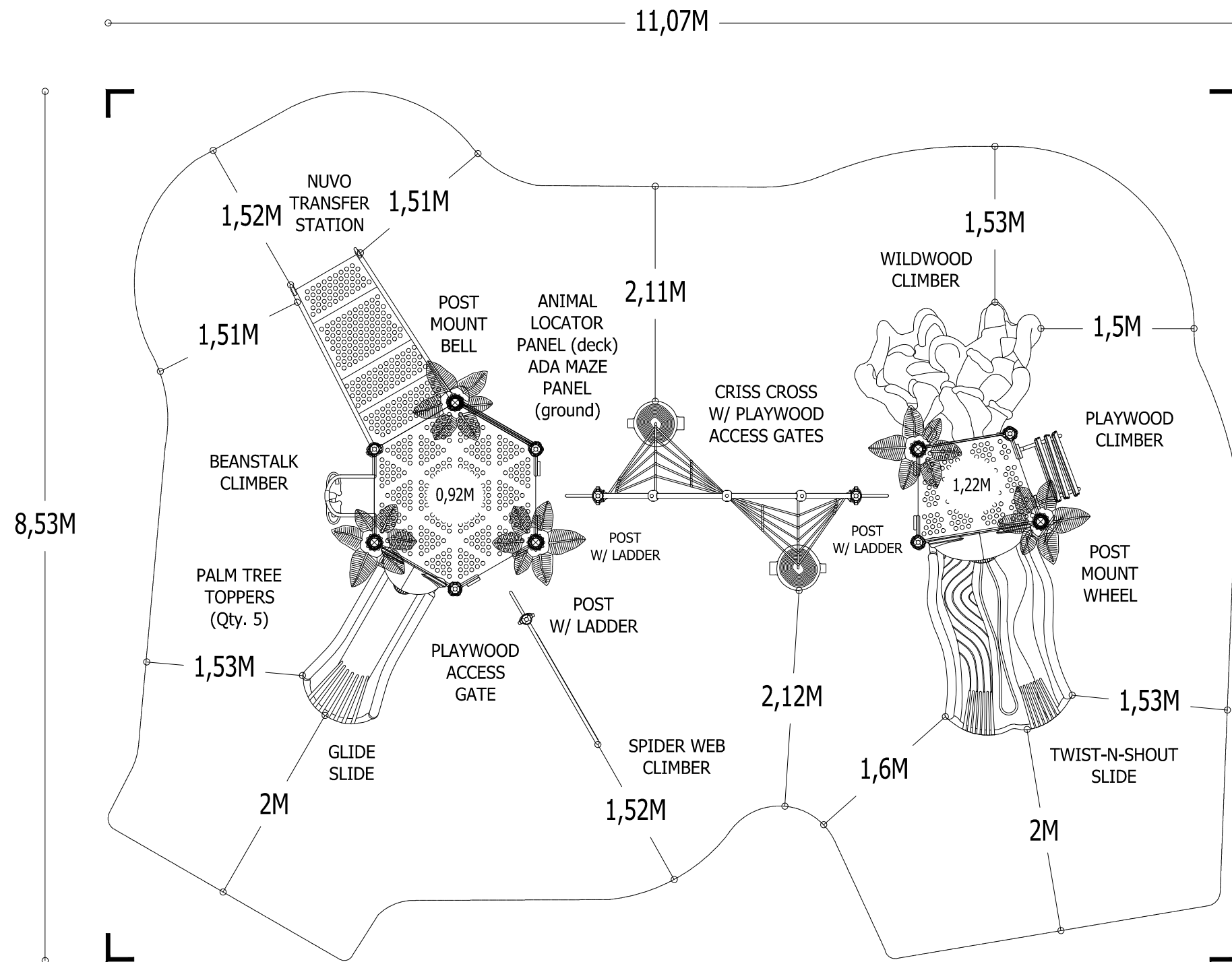

*PLAYGROUND SUPERVISION REQUIRED

ANTIGUA
 INTERNATIONAL COLLECTION

Antigua

Design Number: IPL-1515A - Bill Of Material

Ref. No.	Part No.	Description	Quantity
Posts			
1	ZZCH0018	3.5in OD x 124in STEEL POST W/RIVETED CAP	3
2	ZZCH0028	3.5in OD x 136in STEEL POST W/ RIVETED CAP	2
3	ZZCH0039	3.5in OD x 148in STEEL POST W/O CAP	1
4	ZZCH0049	3.5in OD x 160in STEEL POST W/O CAP	2
5	ZZCH0059	3.5in OD x 172in STEEL POST W/O CAP	2
6	ZZCH0297	POST W/ LADDER CLIMBER (36in OR 48in DECK)	3
Decks & Kick Plates			
7	zzCH0619	FULL HEX COATED DECK ASSEMBLY	1
8	ZZCH0636	DOUBLE SLIDE COATED DECK ASSEMBLY	1
ADA Items			
9	ZZCH0679	NUVO- 36in TRANSFER STATION	1
Slides			
10	ZZCH2727	TWIST AND SHOUT (48in DECK)	1
11	ZZCH3127	GLIDE SLIDE (36in DECK)	1
Activity Panels			
12	ZZCH4290	POST MOUNTED STEERING WHEEL	1
13	ZZCH4328	ANIMAL LOCATOR PANEL	1
14	ZZCH4396	ACCESSIBLE MAZE PANEL	1
Barriers			
15	ZZCH4658	PLAYWOOD ACCESS GATES	3
Climbers			
16	ZZCH6839	THE WILDWOOD CLIMBER (48in DK)	1
17	ZZCH8100	BEANSTALK CLIMBER (36in DECK)	1
18	ZZCH8256	48in PLAYWOOD CLIMBER	1
Ground Zero Climbers			
19	ZZCH6826	SPIDER WEB CLIMBER	1
20	ZZCH8389	THE CRISS CROSS	1
Audible Activities			
21	ZZCH4557	8in BELL (POST MOUNT)	1
Roofs & Arches			
22	ZZCH9809	PALM TREE TOPPER	5
Additional Tool & Maintenance Kits			
23	ZZCHGUID	CHALLENGER GUIDELINES	1
24	ZZUN2739	CANADIAN/EN COMPLIANCE KIT FOR RUMBLE/TWIST&SHOUT SLIDES	1
25	ZZUN9910	SURFACING WARNING LABEL KIT	1
26	ZZUN9935	PIPE SYSTEMS MAINTENANCE KIT W/O AEROSOL	1
27	ZZXX0049	EN & JPFA HOLE PLUG KIT FOR ECO-ARMOR (150 COUNT)	1
28	ZZXX0109	EN-1176 LABEL	1

Antigua

Design Number: IPL-1515A - Compliance and Technical Data

Reference Document: EN1176:2008

Ref. No.	Part No.	Qty.	Description	Unit EN Status	Total Weight (lbs)	Pre-Consumer Recycled Content (lbs)	Post-Consumer Content (lbs)	CO2e Footprint (kgs)	Users	Install Hours	Concrete (Yds3)	Active Play Events
1	ZZCH0018	3	3.5in OD x 124in STEEL POST W/RIVETED CAP	Certified	116.73			161	0	3.00	0.38	0
2	ZZCH0028	2	3.5in OD x 136in STEEL POST W/ RIVETED CAP	Certified	87.02			117	0	2.00	0.25	0
3	ZZCH0039	1	3.5in OD x 148in STEEL POST W/O CAP	Certified	46.21			59	0	1.00	0.13	0
4	ZZCH0049	2	3.5in OD x 160in STEEL POST W/O CAP	Certified	99.82			127	0	2.00	0.25	0
5	ZZCH0059	2	3.5in OD x 172in STEEL POST W/O CAP	Certified	103.22			136	0	2.00	0.25	0
6	ZZCH0297	3	POST W/ LADDER CLIMBER (36in OR 48in DECK)	Certified	158.43			222	3	1.50	0.54	3
7	zzCH0619	1	FULL HEX COATED DECK ASSEMBLY	Certified	151.26			444	6	1.50	0.00	0
8	ZZCH0636	1	DOUBLE SLIDE COATED DECK ASSEMBLY	Certified	63.86			185	3	1.00	0.00	0
9	ZZCH0679	1	NUVO- 36in TRANSFER STATION	Certified	239.72			418	2	3.50	0.12	0
10	ZZCH2727	1	TWIST AND SHOUT (48in DECK)	Certified	183.86			656	4	3.00	0.06	1
11	ZZCH3127	1	GLIDE SLIDE (36in DECK)	Certified	99.73			374	3	2.00	0.03	1
12	ZZCH4290	1	POST MOUNTED STEERING WHEEL	Certified	7.83			44	1	0.25	0.00	1
13	ZZCH4328	1	ANIMAL LOCATOR PANEL	Certified	47.77			329	1	0.50	0.00	1
14	ZZCH4396	1	ACCESSIBLE MAZE PANEL	Certified	17.90			158	1	0.50	0.00	1
15	ZZCH4658	3	PLAYWOOD ACCESS GATES	Certified	100.32			225	0	1.50	0.00	0
16	ZZCH6839	1	THE WILDWOOD CLIMBER (48in DK)	Certified	168.30			820	6	2.50	0.09	1
17	ZZCH8100	1	BEANSTALK CLIMBER (36in DECK)	Certified	69.63			273	1	1.00	0.03	1
18	ZZCH8256	1	48in PLAYWOOD CLIMBER	Certified	69.88			125	2	2.00	0.06	1
19	ZZCH6826	1	SPIDER WEB CLIMBER	Certified	41.19			572	2	1.00	0.00	1
20	ZZCH8389	1	THE CRISS CROSS	Certified	180.49			1,781	4	2.00	0.06	1
21	ZZCH4557	1	8in BELL (POST MOUNT)	Certified	5.15			44	1	0.25	0.00	1
22	ZZCH9809	5	PALM TREE TOPPER	N/A	71.65			535	0	2.50	0.00	0
23	ZZCHGUID	1	CHALLENGER GUIDELINES	N/A	0.00			1	0	0.25	0.00	0
24	ZZUN2739	1	CANADIAN/EN COMPLIANCE KIT FOR RUMBLE/TWIST&SHOUT SLIDES	Certified	2.09			61	0	1.00	0.00	0
25	ZZUN9910	1	SURFACING WARNING LABEL KIT	N/A	0.05			1	0	0.25	0.00	0



Antigua

Design Number: IPL-1515A - Compliance and Technical Data

Reference Document: EN1176:2008

Ref. No.	Part No.	Qty.	Description	Unit EN Status	Total Weight (lbs)	Pre-Consumer Recycled Content (lbs)	Post-Consumer Content (lbs)	CO2e Footprint (kgs)	Users	Install Hours	Concrete (Yds3)	Active Play Events
26	ZZUN9935	1	PIPE SYSTEMS MAINTENANCE KIT W/O AEROSOL	N/A				57				
27	ZZXX0049	1	EN & JPFA HOLE PLUG KIT FOR ECO-ARMOR (150 COUNT)	Certified	4.51			158	0	0.00	0.00	0
28	ZZXX0109	1	EN-1176 LABEL	Certified	0.01			0	0	0.50	0.00	0
Totals:					2,136.63	303	498	8,082	40	38.50	2.24	14
					961.48 Kg	136 Kg	224 Kg	8 Metric Tons				1.70 m3



Antigua

Design Number: IPL-1515A - Compliance and Technical Data

Reference Document: EN1176:2008

Ref. No.	Part No.	Qty.	Description	Unit EN Status	Total Weight (lbs)	Pre-Consumer Recycled Content (lbs)	Post-Consumer Content (lbs)	CO2e Footprint (kgs)	Users	Install Hours	Concrete (Yds3)	Active Play Events
----------	----------	------	-------------	----------------	--------------------	-------------------------------------	-----------------------------	----------------------	-------	---------------	-----------------	--------------------

EN1176:2008

This custom structure, drawing number IPL-1515A, has been designed to meet the general safety requirements of EN1176:2008. These requirements have been established with the consideration of the risk factor on available data. The items listed as certified have been reviewed and approved by a third party certification service. In addition to the product listing the overall layout and design of this structure, as shown in the plan, was completed in accordance with the general safety requirements of EN1176:2008.

Installation Times

Installation times are based on one experienced installer. A crew of three experienced individuals can perform the installation within the given time, each member working 1/3 of the given hours. [E.g. Installation Time = 30 hours. For a crew of three, each member will work 10 hours on the installation for a total of 30 hours on the project.]

Carbon Footprint

The CO2e (carbon footprint given in Kilograms and Metric Tons) listed above is a measure of the environmental impact this play structure represents from harvesting raw materials to the time it leaves our shipping dock. Playworld Systems nurtures a total corporate culture that is focused on eliminating carbon producing processes and products, reducing our use of precious raw materials, reusing materials whenever possible and recycling materials at every opportunity. Playworld Systems elected to adopt the Publicly Available Specification; PAS 2050 as published by the British Standards Institute and sponsored by Defra and the Carbon Trust. The PAS 2050 has gained international acceptance as a specification that measures the greenhouse gas emissions in services and goods throughout their entire life cycle.

Pre-Consumer Recycle Content

A measurement, in pounds, that qualifies the amount of material that was captured as waste and diverted from landfill during an initial manufacturing process and is being redirected to a separate manufacturing process to become a different product. E.g. 100% of our Aluminum Tubing is made from captured waste material during the manufacturing process of extruded Aluminum products such as rods, flat bars and H-channels.

Post-Consumer Recycle Content

A measurement, in pounds, that qualifies the amount of material that was once another product that has completed its lifecycle and has been diverted from a landfill as a solid waste through recycling and is now being used in a Playworld Systems' product. E.g. **20% to 40% of the steel in our steel tubing and sheet steel have been diverted from landfills. Automobiles are scrapped and recyclable steel is purchased by the steel mill that produces our raw product.

** The amount of Post-Consumer recycled steel fluctuates daily based on the availability of the recycled steel.